

E D

G E



innerSPACE

Edge Workstation

Edge Workstations are perfect for all office situations from single standing desks, against walls or workstation clusters configured with screens. Also available with technician height adjustable leg options.

Configurations include a straight or corner desk, benching (back to back), and 120 degree. Privacy screens can be supported which are clamped to the worktop or independently connected to the leg bracket.

Cable management options includes a central cable tray, basket and soft wiring umbilicals.

Desktop accessories also available including monitor arms, desktop power and shelving.

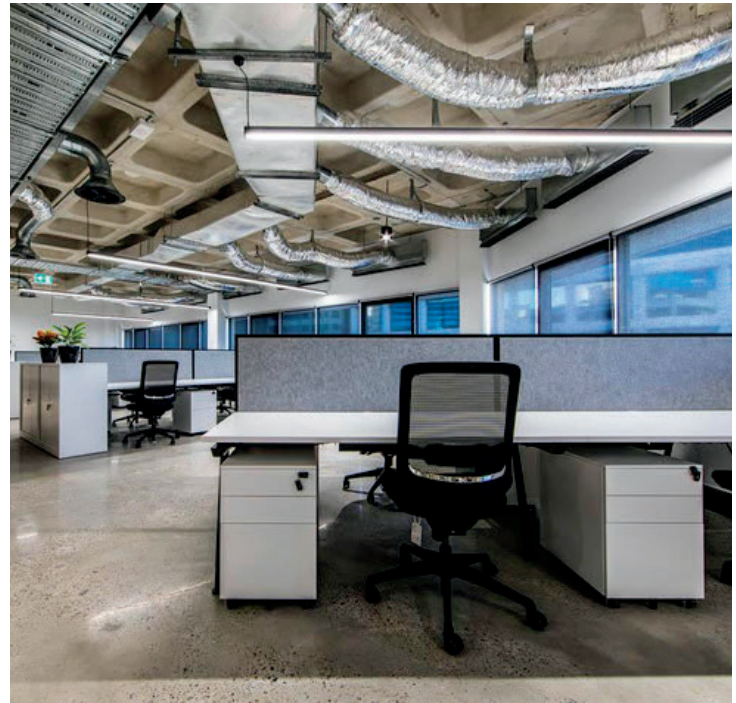

WORKTOPS

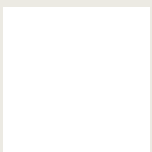

Melamine

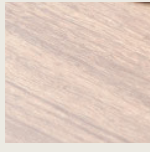

Melamine

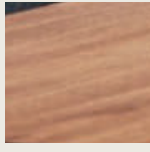

Veneer

FRAME



White



Black

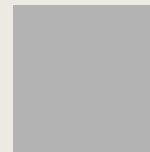

Silver

SPECIFICATIONS

WORKTOP DIMENSIONS: 1500, 1800mm Long x 600, 800mm Deep. Others available on request

WARRANTY: 10 years

FINISHES

Worktops are available in a range of sizes and finishes from Laminex and Polytec.

Legs come in white, black and silver powder coat as standard with other colours available upon request.



CONFIGURATIONS

WORKTOP SIZES



Single

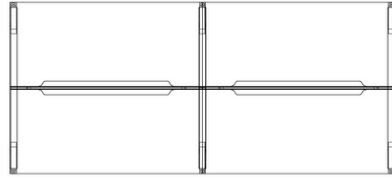

**Back to Back Cluster -
2, 4, 6 or 8 person**

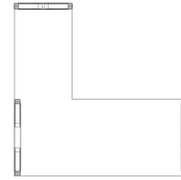

L Shaped

Screens Types



Framed with accessory rail
Fabric or Echopanel



Frameless Recycled PET
Custom colours



Perspex
Clear, frosted or coloured

Optional Accessories



Screen hung Bookshelves, Name Plates, Paper trays, Task Lighting and Divider screens.



Above or below desk Power/Data, Monitor Arms, Laptop holders, CPU holders and Soft Wiring.

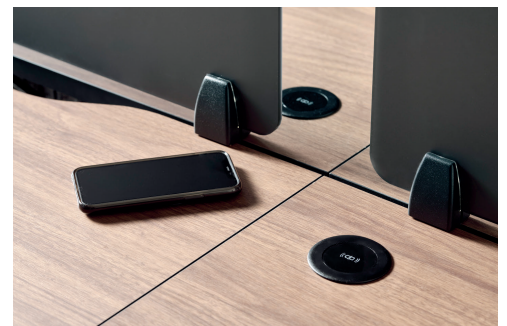

In desk chargers