

GOAL POST



innerSPACE

Goalpost Workstation

Goalpost Workstations features a straight leg profile which is perfect for all office situations from single standing desks, against walls or workstation clusters configured with screens.

Configurations includes a straight or corner desk, benching (back to back), and 120 degree.

Privacy screens are clamped to the worktop or independently connected to the leg bracket.

It has a cable management options which includes a central cable tray, basket and soft wiring umbilicals. Desktop accessories also available including monitor arms, desktop power and shelving.



WORKTOPS

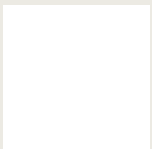

Melamine

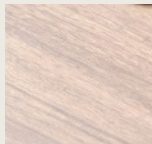

Melamine

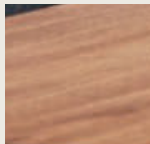

Veneer

FRAME

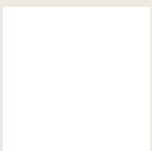

White

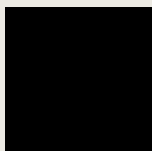

Black

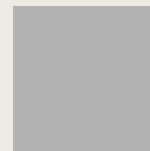

Silver

SPECIFICATIONS

WORKTOP DIMENSIONS: 1500, 1800mm Long x 600, 800mm Deep. Others available on request

WARRANTY: 10 years

FINISHES

Worktops are available in a range of sizes and finishes from Laminex and Polytec.

Legs come in white, silver and black powder coat as standard. Other colours available upon request.



CONFIGURATIONS

WORKTOP SIZES



Single

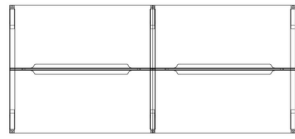

Back to Back Cluster -
2, 4, 6 or 8 person

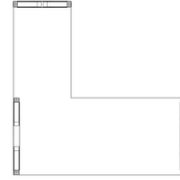

L Shaped

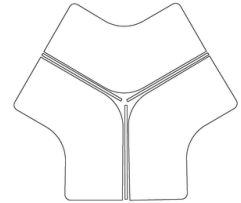

120 Degree

Screens Types



Framed with accessory rail
Fabric or Echopanel



Frameless Recycled PET
Custom colours



Perspex
Clear, frosted or coloured

Optional Accessories



Screen hung Bookshelves, Name
Plates, Paper trays, Task Lighting
and Divider screens.



Above or below desk
Power/Data,
Monitor Arms, Laptop holders,
CPU
holders and Soft Wiring.

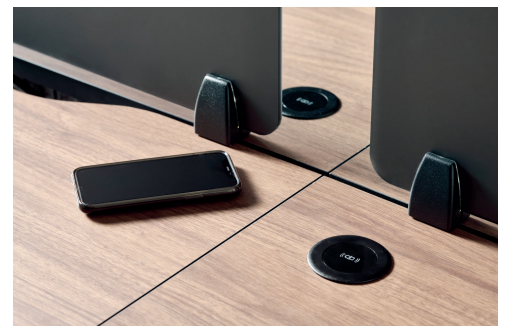

In desk chargers