

LAND SCAPES



innerSPACE

Landscapes Workstation

Create the perfect landscape where you work.

Landscapes is ideal for individuals, teams and mobile workers.

With a one leg design combined with an adjustable rail system, many combinations can be achieved. This includes a single desk, a team workstation, a hot desk, office desk, or a meeting tables.

Custom designed tapered leg, in levelling glides, integrated cable management, and multiple screen options available.



WORKTOPS

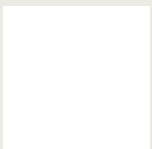

Melamine

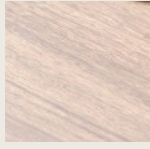

Melamine

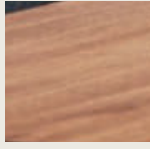

Veneer

FRAME



White

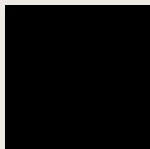

Black



Ashwood

SPECIFICATIONS

WORKTOP DIMENSIONS: 1500, 1800mm Long x 600, 800mm Deep. Others available on request

WARRANTY: 10 years

FINISHES

Worktops are available in melamine or timber veneer.

Legs are available in white and black as standard with a variety of powdercoat colours available upon request.

With optional Ashwood woodgrain-look finish on the legs. Frame under structure is in black powder coat.

CONFIGURATIONS

WORKTOP SIZES



Single

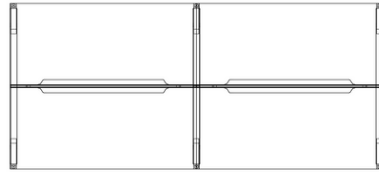

**Back to Back Cluster -
2, 4, 6 or 8 person**

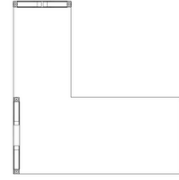

L Shaped

Screens Types



Framed with accessory rail
Fabric or Echopanel



Frameless Recycled PET
Custom colours



Perspex
Clear, frosted or coloured

Optional Accessories



Screen hung Bookshelves, Name Plates, Paper trays, Task Lighting and Divider screens.



Above or below desk
Power/Data,
Monitor Arms, Laptop holders,
CPU
holders and Soft Wiring.

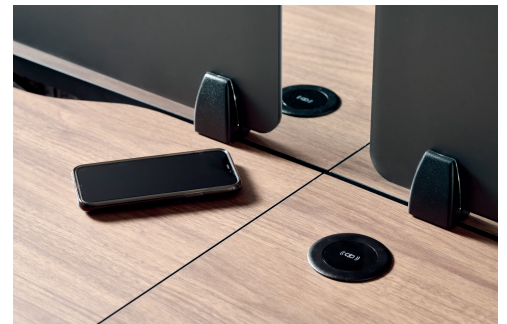

In desk chargers

MEETING TABLES



Sizes: from 1800L x 800D.
Custom sizes and multi leg options available

FREESTANDING DESK



Sizes: 1500, 1800mm L x 600, 800mm D
Custom sizes available